

INSTALLATION AND OPERATING GUIDE

AUTOMATIC FERTILISING SYSTEM

GARDEN HOSE TAP OR
DRIP CONNECTION

2005HB and
2030HB models
light duty designed
for on/off operation.
Premium 1010HB
model can be left
under constant
pressure <700kPa



www.ezflo.com.au



© 2017, EZ-FLO Fertilizing

CAUTION: Installing your system improperly can cause risk of water contamination and pose health risks. Do not attach your feeder to a hose tap or sprinkler line that does not have a hose vacuum breaker or back flow preventer. Back flow preventer is not included with system.

INSTALLING YOUR EZ-FLO: GARDEN HOSE & DRIP SYSTEMS

Out of the box, assembled



Ready to fertigate

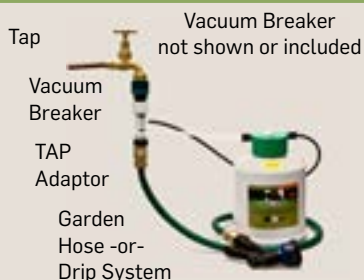

Step 1

Determine the type of installation that is correct for your system (hose or drip) and insert the correct FLO disc if necessary (see "**Flow Requirements Section**")

Step 2

Install the **EZ-FLO** tap adapter in the correct position as shown in the illustrations. The EZ 1010-HB may be installed before or after a timer. The tank is capable of handling constant pressure.

Step 3

Attach tubing to the hose tap adapter fitting. Slide the Black tubing over the barb next to the blue mark carefully to avoid stressing the fitting. Repeat with the Clear tubing next to the Green mark.

Step 4

Attach tubing to the green tank cap.

Do not remove the blue and green cap connector nuts.

Slightly loosen each nut and insert the Black tubing through the center of the Blue nut until it stops. Once it stops hand tighten the blue nut. Repeat with the Clear tubing and the Green nut.

Additional Installation Notes:

If one is not already installed a hose vacuum breaker should be installed to use an **EZ-FLO** system per local plumbing codes (**not Included**) Back flow prevention may not be required on bore irrigation systems but is still recommended. When possible the tap adapter fitting should always be the last component installed in any configuration. Filters, & pressure regulators

should not be installed after the hose tap adapter. Unit includes 1.2 m of clear and 1.2 m of black tubing, you may trim tubing to necessary length.

NOTE:

Light duty models 2000 series are designed for on/off operation and not designed to be left unattended under pressure.

GARDEN HOSE & DRIP CONNECTION TANK ASSEMBLY & PARTS LIST



Hose tap adapter



liquid adapter, fit when using liquid fertiliser



Flo Disc Set
K-INSKFD
white, black and red disc

FLOW REQUIREMENTS: LOW FLOW IN HOSE & DRIP SYSTEMS



<https://youtu.be/ogpIwf31A-0>

Drip systems with less than 8 litres per minute (lpm) water flow may require an EZ-FLO Flo-Disc in order to inject solution into the drip system. There are three discs provided for these conditions.

Important: You must have colored fertiliser in the EZ-FLO tank or food dye to adjust the system. Let the system run for a few minutes to make sure the fertiliser is not flowing before installing or changing the Flo-Disc. If there is no color in the tube, the system is not flowing and a more restrictive Flo-Disc is required for operation.

Flo-Disc 8 to 4 lpm
 Flo-Disc 4 to 2 lpm
 Flo-Disc 2 to 0.5 lpm

When using a flo disc always pre dilute 1 part fertiliser to 4 parts water

Hose Tap Adaptor

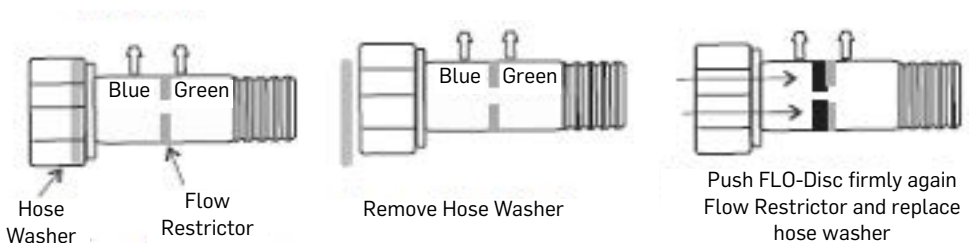

Step 1

Estimate your water flow by multiplying the number of drip emitters on your system by their litres per hour flow rating. (If you do not know your water flow you can use trial & error starting without a Flo-Disc. If no color is present in the clear line insert a Flo-disc starting with the white)

Step 2

Remove the washer from the swivel nut on the Hose tap adaptor. For easy removal, use pliers to grab the O-Ring tab or a plain end screw driver.

Step 3

Push the proper **Flo-Disc** into the hose tap adaptor until it presses firmly against the flow restrictor in the center of the hose tap adaptor. The water flow will hold the disc in place.

Step 4

Replace the hose tap adaptor hose washer and follow steps 2 through 4 in the **"Installing your EZFLO"** in these instructions.

Note: The Flo-Disc is not intended for pressure reduction and cannot be used for this purpose. The Flo-Disc will create additional bypass through the tank when necessary to speed up injection.

ADDING FERTILISER & FEEDING SETTINGS



2005HB, 2.8 liter



1010HB, 3.8 liter



2030HB, 11.4 liter

Step 1

Add the fully concentrated product and select the appropriate tap setting based on the manufacturers recommended coverage rate. **Products do not require dilution or premixing unless using a Flo-Disc or the manufacturer's recommendation**

Step 2

Fill the tank with water until all air is out of the tank. The system will mix the products automatically when the water is turned on.

Step 3

Screw tank cap on the tank and connect tubing to the cap and hose tap adaptor
Connect blue to blue and green to green. The tubing slides over the connectors on the hose tap adaptor and into the connector on the cap.

Step 4

Set the flow adjustment on the cap to fast feed for quick feeding and to slow feed to feed slowly every time you water. You can also feed at these approximate rates

Slow 1000:1 100ml per 100 litres of water used
 #1 500:1 200ml per 100 litres of water
 #2 250:1 400ml per 100 litres of water
 Fast 100:1 1 litre per 100 litres of water

To refill - shut off pressure to tank, unscrew tubing from the cap, pour the water out of the tank and go to step one above.

Note: All feed rates are approximate and not guaranteed by EZ-FLO due to the high amount of variables resulting from differences in irrigation system configuration, product quality, viscosity, and specific gravity. Feed rates and ratios are provided for convenience only. EZ-FLO feeders should be used for general application of liquid and water soluble products only and are not marketed as a direct replacement for chemical siphon feeders.

For safe fertilising practices EZ-FLO recommends the plants be fed at half or 50% of the manufacturers recommended amount for the first application to prevent any damage to the plants or landscape.



EZ-FLO FREQUENTLY ASKED QUESTIONS

WHAT PRODUCTS CAN I USE WITH THE SYSTEM?

Any liquid or water soluble powder may be used in the system. Water soluble powders do not need to be dissolved to work in the system. The EZ-FLO process dissolves, mixes, and measures for you. If your product is clear you may add food coloring or dye so the product will be visible in the clear output tube. Fit liquid adaptor when using liquids.

HOW DO I KNOW WHEN THE FERTILISER IS GONE?

When the system is operating (water flowing) the clear tube will fill with the color of your fertiliser. When the systems is operating and the tube is running clear, the system is out of fertiliser.

MY FERTILISER IS GONE BUT THE TANK IS FULL OF WATER

The EZ-FLO system will always be full of fluid since it replaces the product with fresh water utilising a patented process to layer the incoming water over the heavier fertiliser solution. This process is similar to oil on water or whipped cream on gelatin.

HOW DO I KNOW THE SYSTEM IS WORKING?

When water is flowing through your garden hose or drip system, the color from the fertiliser will completely fill the clear tube. The color depends on the fertiliser or dye color. The color in the tube may be lighter or darker depending on how much fertiliser was put into the tank and/or the injection setting selected on the cap. If you have a full tank of fertiliser and do not see color in the clear tube, refer to the Installation and Flow Requirements sections of this guide.

MY SYSTEM IS RUNNING BUT THE LINE IS STILL CLEAR

- First check that your system has water flowing and is not just under pressure. The tube will only show color when the water is flowing.
- Make sure the tank was filled with the proper amount of fertiliser and dye was added if the fertiliser did not contain a dye. Also, confirm all air was removed from the tank by topping off with water.
- Check that the included hose tap adaptor fitting is installed according to the Installation section. You may need to rearrange your filter, pressure regulator, and/or timer so our injector fitting is last.
- Check the Flow Requirements section to determine if you need a Flo Disc or that the correct Flo Disc was selected.
- If installed in a sprinkler line adjust the ball valve connector (CBV) according to the instructions provided with the connector. If the system was installed in a sprinkler line and a coupling ball valve (CBV) connection was not used, one must be installed for proper function.

MY SYSTEM IS FEEDING TOO FAST

Check that you have selected the appropriate feed setting. Also, if you used a Flo Disc during installation, make sure the proper disc was selected. Any Flo-Disc will speed up the injection rate of the system.

If using a coupling ball valve connection (CBV) for irrigation pipe, make sure the valve is properly calibrated. Opening the valve will slow the feed rate for your system.